

1 Locate and mark position of skylight on ceiling. Break small opening and inspect roof space for obstructions. Check that work is clear of electrical and other hazards. Mark position of centre of skylight by drilling through roof sheet. Mark internal size and position of skylight and use as set out line on roof sheet. Mark on outside a line parallel to set out line with 70mm allowance for each flashing. Allow 115mm for soaker tray at top.

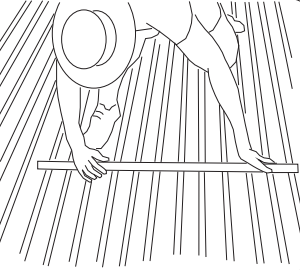

6 Install soaker at top. Note generous bead of silicon sealant.

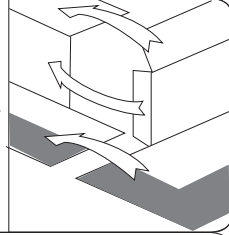
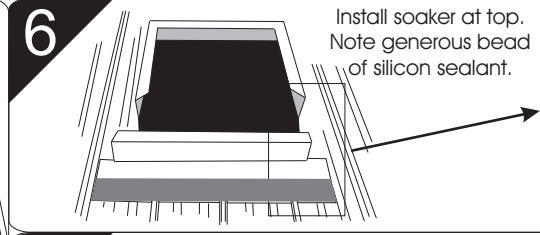

2 Cut out opening in roof sheet using power nibbler or tin snips. Do not use disc saw. Take care not to cut electrical flex. Remove all swarf.

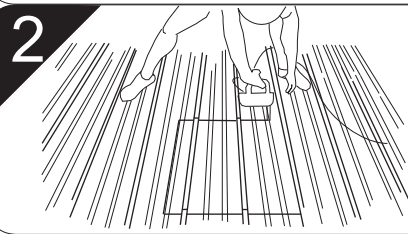

7 Seal all lapped mitted corners and ends of ribs. Anticapillary cuts associated with overflashing on sheet join.

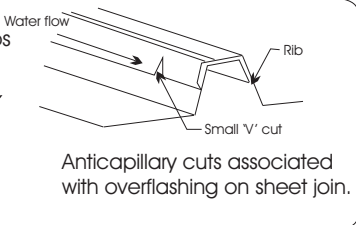

3 Remove insulation.

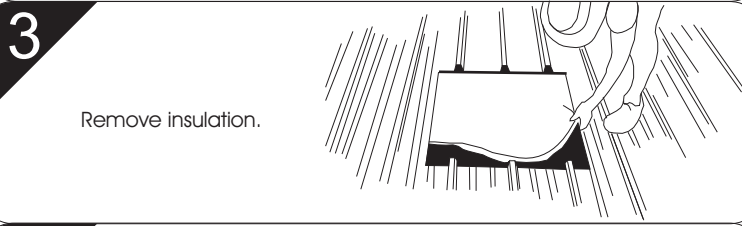

8 Cut out ceiling joists and ceiling lining. Note: Before cutting ceiling joists, ensure adequate structural supports are provided.

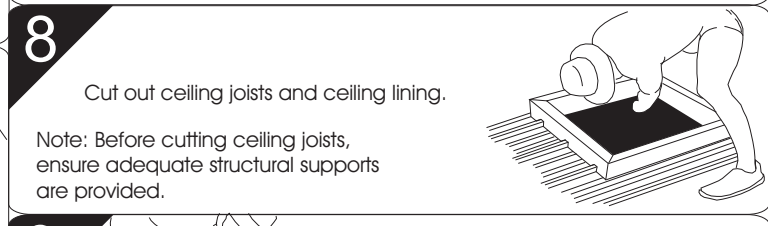

4 Prepare ends of flashing kit to form lapped mitre corners on top and allow for laps on sides.

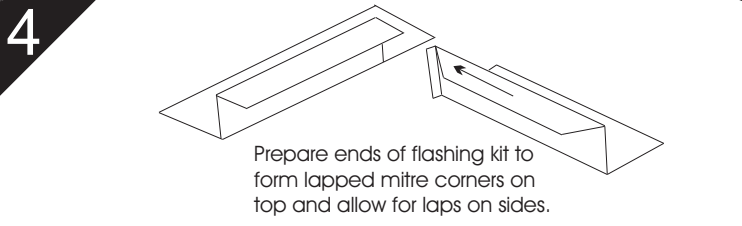

9 Fit skylight base. Pop rivet or use self-tapping screws to fix to flashing kit on sides.

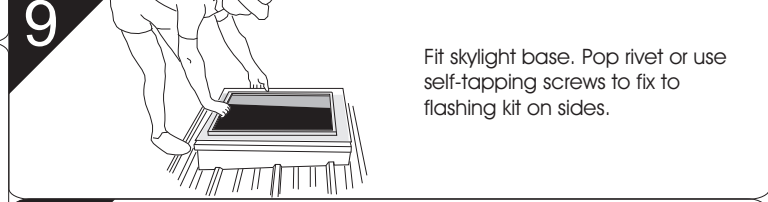

5 Install flashing kit into opening using generous beads of silicon sealant at all overlapping sections, pop rivet at 75mm centres along length of pan and at least 3 pop rivets across pan.

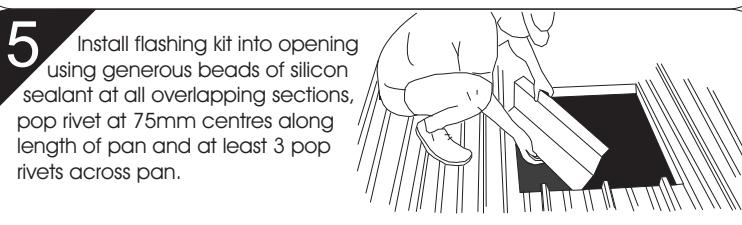

10 Fit dome with trims supplied. Pop rivet trims at each corner taking care not to penetrate dome. NOTE: IT IS RECOMMENDED THAT INSTALLATION IS WATER TESTED AT THIS STAGE TO ENSURE THAT ALL JOINTS WERE ADEQUATELY SEALED. Your Regent Steel Deck Tubelight is complete.

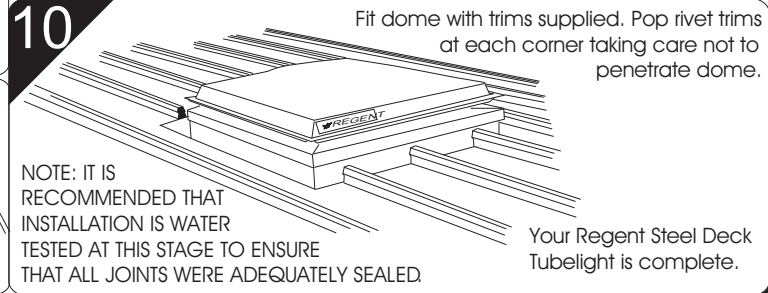

The product described herein is protected by one or more of the following: Australian Patent Nos 688444, 686419 and 712432; Australian Registered Design Nos 127024, 118780 and 107995. The skylight system illustrations contained in this brochure are the sole property of Regent Skylight Systems Pty. Ltd. and are reserved under copyright law. It is the responsibility of the user to ensure that the selected skylight system complies with the relevant building codes and authorities requirements. Regent Skylight Systems Pty. Ltd. reserves the right to improve or modify the skylight systems at any time. Zinalume® and Colorbond® are registered trademarks of BlueScope Steel Limited. Corrolux® is a registered trademark of Thomas Deutsch (Regent Sheet Metal Pty Ltd)

REGENT SKYLIGHT SYSTEMS PTY. LTD.

" The Ultimate in Skylights and Ventilation Products! "

www.regentskylights.com.au Technical Sheet INST/SSDS/17082009/001.3